



## ROOMS



### PREMIER ROOM

If you're looking for a legendary Las Vegas stay, look no further than our newly renovated **Premier Rooms**, offering dramatic colors, intriguing textures, and supreme spaciousness.

Featuring stunning Las Vegas Strip scenery or Las Vegas Country Club greenery outside the expansive windows, these freshly renovated rooms offer everything you need to make your stay the stuff of legend.



### LUXE ROOM

The modern décor and spaciousness of the new **Luxe Room** at Westgate Las Vegas Resort & Casino offers all the comforts of home with 400 square feet of space and room for two guests.

Featuring spectacular views of the Las Vegas Strip or Las Vegas Country Club golf course, the beautifully decorated Luxe Room creates the ideal setting for an amazing Las Vegas getaway.



## SUITES



### LANAI SUITE

The remodeled 440 sq. ft. **Lanai Suite** offers complete comfort and relaxation with modern touches for your stay. Each room features a 60" Smart TV with internet and application capabilities.



### LUXURY SUITES

The premium selection of **Luxury Suites** offers visitors an array of superb amenities and a selection of suite types. Choose from luxury one or two Bedroom Suites, with views of the world-famous Las Vegas Strip and more!

## AMENITIES



### EDGE STEAKHOUSE

**Edge Steakhouse** takes you to the cutting edge of perfection with an extensive menu blending traditional American steakhouse favorites with an exciting array of specialty appetizers, creative entrées and innovative side dishes.



### SERENITY SPA BY WESTGATE

**Serenity Spa** is a rejuvenating oasis amid the bustle and fun of one of the world's most exciting places. Located adjacent to the pool, enjoy a wide range of treatments from Swedish massage and soothing body scrubs, to cleansing facials.

# WESTGATE LAS VEGAS RESORT & CASINO





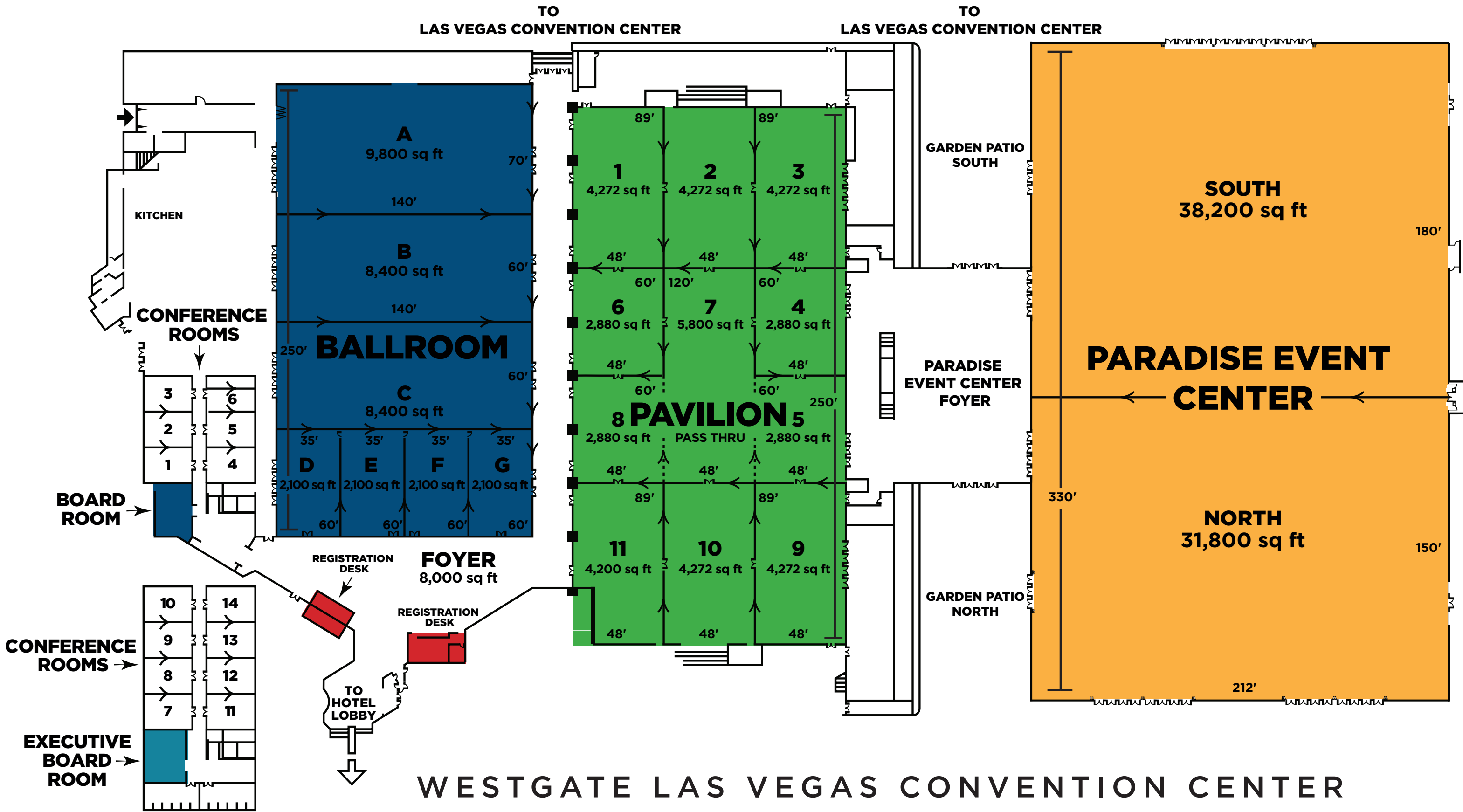

	DIMENSION	CEILING	SQ FT	RECEPTION	SCHOOLROOM	ROUNDS	THEATER	U-SHAPE	HOLLOW SQUARE	CONF. STYLE
PARADISE EVENT CENTER									EXHIBITS	8 x 1010 x 10
PARADISE EVENT CENTER (Combined)	330' 2" x 212'	24' 9"	70,000	8,045	4,700	6,120	8,094		445	365
PARADISE SOUTH	180' 2" x 212'	24' 9"	38,200	4,385	2,334	3,260	4,536			
PARADISE NORTH	150' x 212'	24' 9"	31,800	3,660	2,106	2,630	3,888			

PAVILION									EXHIBITS	8 x 1010 x 1
PAVILION (Combined)	298' x 145'	23' 2"	43,130	4,950	2,985	3,690	5,164		280	245
PAVILION 1,2,3,9,10 (Each Space)	89' x 48'	23' 2"	4,272	500	270	280	460			
PAVILION 4,6 (Each Space)	60' x 48'	23' 2"	2,880	300	180	180	300			
PAVILION 11	89' x 38' to 48'	23' 2"	4,239	450	192	240	352			

BALLROOM								
BALLROOM (Combined)	250' x 140'	12' 4" to 17' 8"	35,000	4,023	2,268	2,880	4,158	
BALLROOM A	140' x 70'	12' 4" to 17' 8"	9,800	1,200	624	640	980	
BALLROOM B & C (Each Space)	140' x 60'	12' 4" to 17' 8"	8,400	1,000	468	580	980	
BALLROOM D, E, F & G (Each Space)	35' x 60'	12' 4" to 17' 8"	2,100	240	132	130	240	

CONFERENCE ROOMS								
CONFERENCE ROOMS 1-6 (Combined) 1st Floor	60' x 58'	10'	3,480	350	230	200	330	
CONFERENCE ROOMS 1-5 (Each Space) 1st Floor	20' x 25'	10'	500	50	24	40	24	202222
CONFERENCE ROOM 6 1st Floor	16' x 25'	10'	400	30	12	30	40	121515
CONFERENCE ROOMS 7-14 (Combined) 2nd Floor	88' x 66'	10'	5,808	660	405	450	550	
CONFERENCE ROOMS 7-14 (Each Space) 2nd Floor	22' x 28'	10'	616	70	30	50	56	202222

BOARD ROOM								
PERMANENT TABLE & CHAIRS	196' 6" X 27'	10'						14

EXECUTIVE BOARD ROOM								
PERMANENT TABLE & CHAIRS	26' X 28'3"	10'					161616	

ROOM CAPACITIES ARE FOR SINGLE USE AT MAXIMUM SET. CAPACITIES OVER 300 PERSONS ARE SUBJECT TO CHANGE BASED ON CLARK COUNTY FIRE MARSHAL APPROVAL.

# CONVENTION SALES

702.732.5631 | Toll Free 800.367.7917 | email [DOS@wgresorts.com](mailto:DOS@wgresorts.com)