

## MEETING SPACE

Number of Meeting Rooms: 15 (including deck and balcony)

Total Meeting Space: 31,829 sq. ft.

Largest Room Space: 15,163 sq. ft. (Grand Ballroom)

Smallest Room Space: 609 sq. ft. (Cypress Boardroom)

Outdoor Meeting Space: Pelican's Pool Deck

Largest Seating Capacity (Number of people): 1,263

Smallest Seating Capacity (Number of people): 10

**Westgate Lakes Resort & Spa**

Group Sales: 866-731-7259

International: 407-355-1110

groups@wgresorts.com

wglakes.com

MEETING SPACE ROOMS	SQUARE FOOTAGE	BANQUET rounds of 8	CLASSROOM	THEATRE	U-SHAPED
Versailles Ballroom	7,605 S.F.	464	546	958	218
Versailles A	2,216 S.F.	139	163	285	65
Versailles B	1,384 S.F.	77	98	173	39
Versailles C	1,859 S.F.	117	132	232	53
Versailles D	2,146 S.F.	131	153	268	61
Fontainebleau Ballroom	6,569 S.F.	406	468	819	185
Fontainebleau A	1,660 S.F.	108	118	207	47
Fontainebleau B	1,247 S.F.	69	89	155	35
Fontainebleau C	1,674 S.F.	105	119	209	47
Fontainebleau D	1,988 S.F.	124	142	248	56
Grand Ballroom	15,163 S.F.	870	1,083	1,895	433
Cypress Boardroom	609 S.F.	18	NA	NA	NA
Pre-Function Space	2,518 S. F.	NA	NA	NA	NA
Veranda Ballroom	2,285	125	150	100	46
Sunset Veranda	1,456	80	100	60	30
Oleander Ballroom	2,408	125	250	125	60
Oleander A	1,204	60	100	75	30
Oleander B	1,204	60	150	50	30
Pelican's Landing Pool Deck	7,500	350	N/A	N/A	N/A

18,000 sq. ft. of Luxurious Meeting Space at Westgate Lakes Resort & Spa. Situated with views of the city and atop seven floors, our flexible meeting and board room space will allow for attendance capacities ranging from 20 –900 people.

**Grand Ballroom: 15,163 S.F.**

**Versailles Ballroom: 7,605 S.F.**

**Fontainebleau Ballroom: 6,569 S.F.**

**Cypress Boardroom: 609 S.F.**

**Pre-Function Space: 2,518 S.F.**

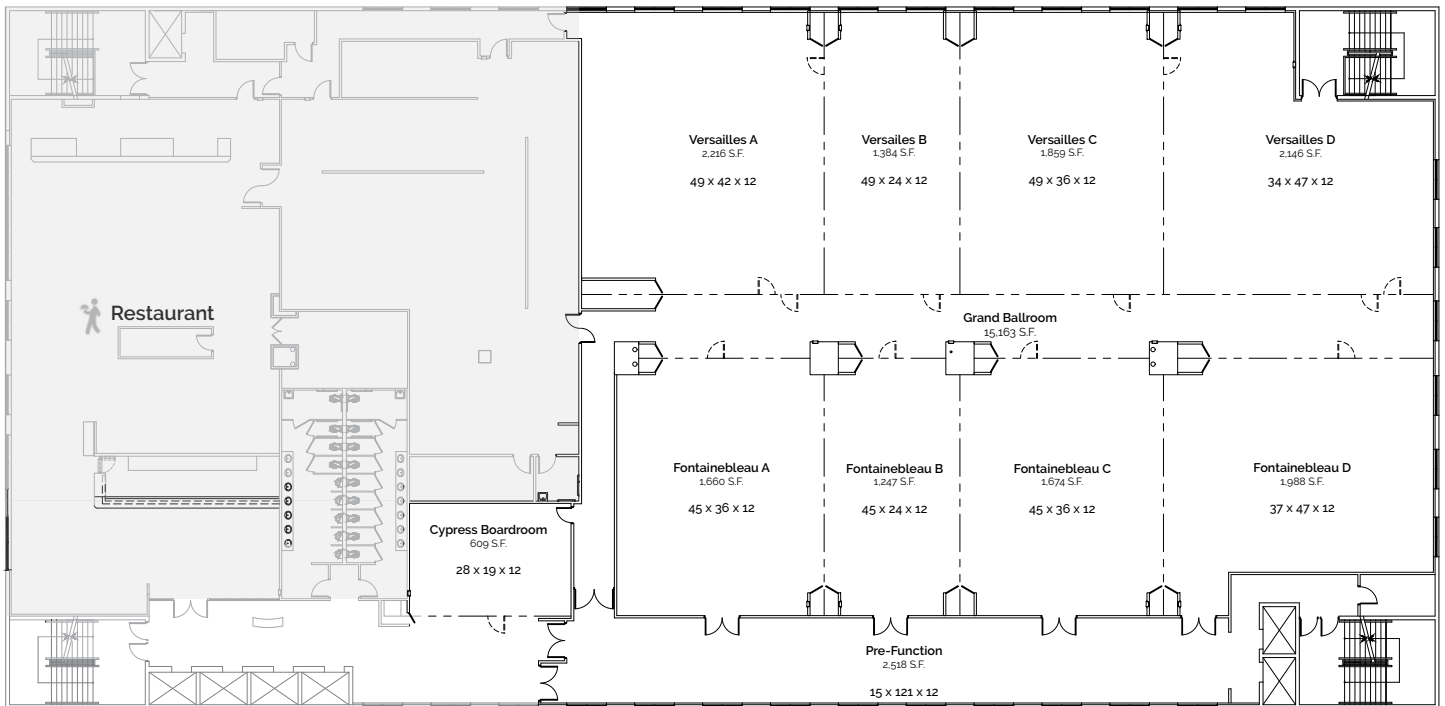

Dimensions LxWxH

